

**HOW TO TELL A PX-2 PENNTEX ALTERNATOR
 FROM A PX-5 DUAL POSITIVE POST PENNTEX ALTERNATOR**

PX-2 Series Information

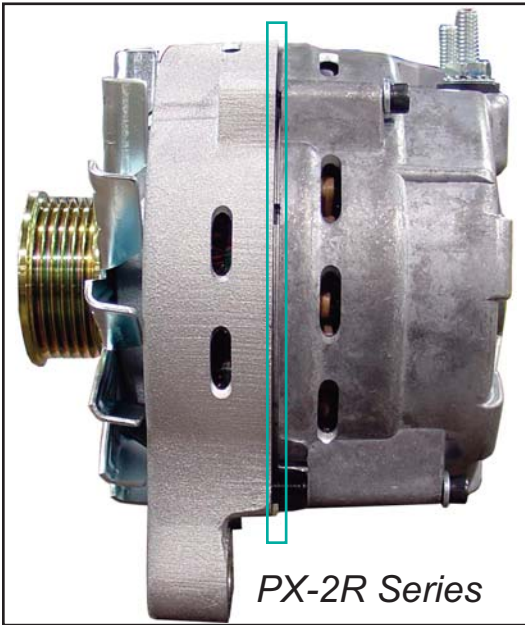

- 1) Note the very small space between the front and rear alternator housings. A PX-2 Series stator is not as wide as a PX-5 stator.
 - 2) A PX-2 Series rear housing is shorter in the rear bearing area because the PX-2 Series rear bearing is not as wide as a PX-5 Series rear bearing.
 - 3) A PX-2 Series alternator is approximately 1.5" shorter overall than a PX-5 Series.
 - 4) A PX-2 Series alternator has one positive and one negative battery post. Both posts are positive on a PX-5_D alternator.
- NOTE:** This same information can be applied to a PX-4G-5 series alternator vs. a PX-5GD series alternator.

PX-5_D Series Information



(The PX-5 Series is available in several mount styles including PX-5GD, PX-5PD, PX-5P2D, PX-5RD, and PX-5TD.)



Scale: none

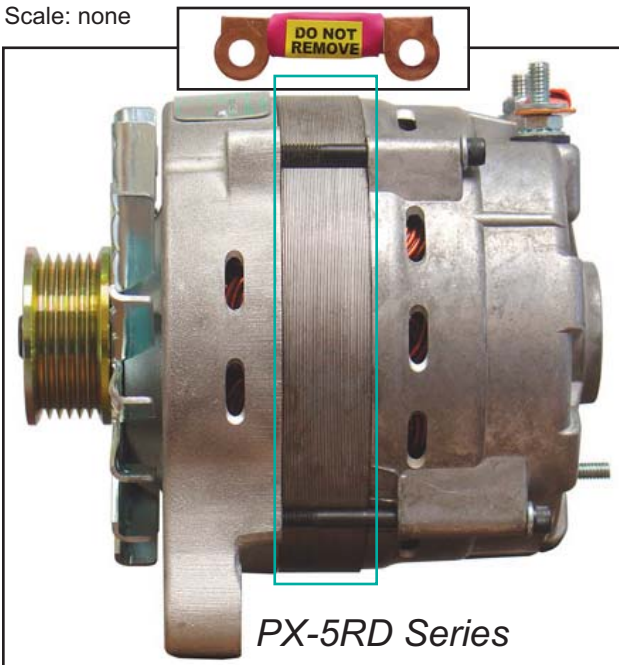

- 1) Note more than one inch of space between the front and rear alternator housings. A PX-5_D Series stator and rotor are longer, so the PX-5_D is longer than a PX-2.
- 2) A PX-5_D Series rear housing is longer because of the wider rear bearing. The front housings usually are the same.
- 3) A PX-5_D Series alternator is approximately 1.5 inches longer overall than a PX-2 Series.
- 4) A PX-5_D Series alternator has 6 negative diodes in the rear housing and 12 positive diodes in heat sinks inside.
- 5) A PX-5_D Series alternator has two positive battery posts with a strap between the posts. 
- 5) Because of the extra length of a PX-5_D, it might also require a special mount bracket to fit some applications.
- 6) Because of the extra stator and rotor size, a PX-5 will put out more amperage than a PX-2. A 250-amp PX-5 is available.
- 7) PX-5 and PX-2 dimensions except for length are the same.
- 8) Because a PX-5_D puts out more amperage, this model is recommended over a PX-2 for extreme-duty applications.

"R" Series mount-style alternators are shown here. Other mount styles are available.

PERFORMANCE, ENDURANCE AND SATISFACTION



**Manufacturers of
 High Efficiency Alternators and
 Mobile Electronic Devices.**

Corporate:
 202 Plaza Drive
 Manchester, PA 17345
 Ph: 717-266-8762
 Fax: 717-266-7803

Manufacturing/ Sales/ Tech/ Warranty:
 7620 Flagstone Drive
 Fort Worth, TX 76118
 Ph: 817-590-2818
 Toll Free: 877-590-7366
 Fax: 817-590-0505, Tech Fax: 817-590-0398

www.penntexusa.com
email: sales@penntexusa.com
tech@penntexusa.com

DIFFERENCES BETWEEN THE SINGLE POSITIVE POST PX-5 AND THE DUAL POSITIVE POST PX-5 ALTERNATOR SOLD SINCE OCTOBER 2005

1) Look for the "D" in the Model Number

2) Look for the Connector Strap that only PX-5 Dual Positive Post Alternators have.

3) Look for diodes in the rear housing

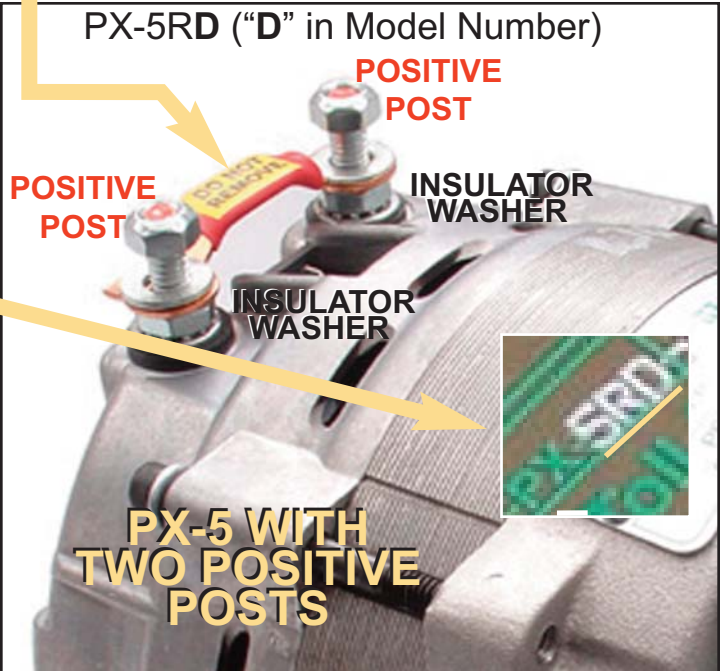
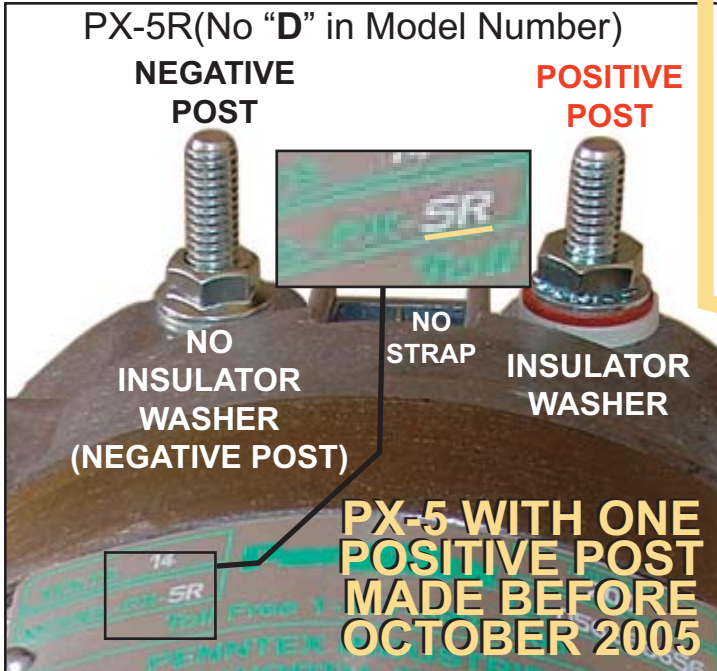

POSITIVE POSITIVE



ALL PX-5 DUAL POSITIVE POST ALTERNATORS HAVE 6 NEGATIVE DIODES IN THE REAR HOUSING WITH A OUTPUT POST CONNECTING STRAP

NO DIODES IN THE REAR HOUSING MEANS THIS IS A PX-2, A PX-4G-5, AN OLDER PX-5 (ON THE LEFT), OR AN ALTERNATOR SOMEONE REBUILT THAT HAS ONE NEGATIVE & ONE POSITIVE POST.

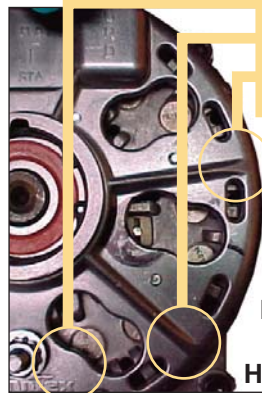
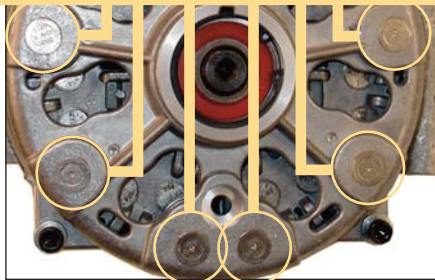

NO DIODE HOLES IN THE HOUSING

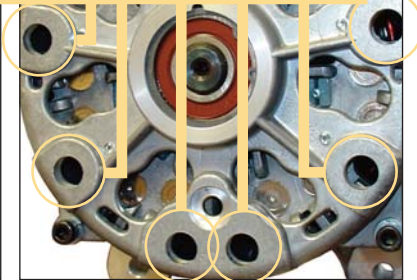

PERFORMANCE, ENDURANCE AND SATISFACTION

PenTex
 INDUSTRIES, INC.

Manufacturers of
 High Efficiency Alternators and
 Mobile Electronic Devices.

Corporate:
 202 Plaza Drive
 Manchester, PA 17345
 Ph: 717-266-8762
 Fax: 717-266-7803

Manufacturing/ Sales/ Tech/ Warranty:
 7620 Flagstone Drive
 Fort Worth, TX 76118
 Ph: 817-590-2818
 Toll Free: 877-590-7366
 Fax: 817-590-0505, Tech Fax: 817-590-0398

www.penntexusa.com
 email: sales@penntexusa.com
 tech@penntexusa.com



Get The PennTex Advantage!
 PERFORMANCE, ENDURANCE AND SATISFACTION

HOW DO THE PENNTEX PX-2, PX-5 AND PX-7 COMPARE?

PX-2P-5

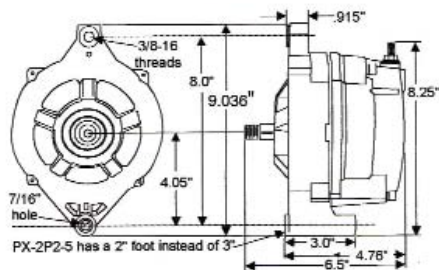

PX-2R-5

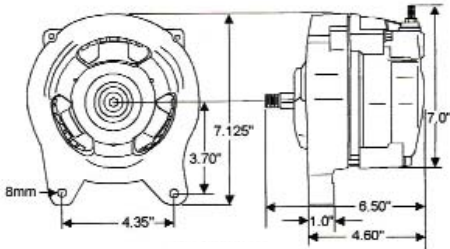

PX-2T-5

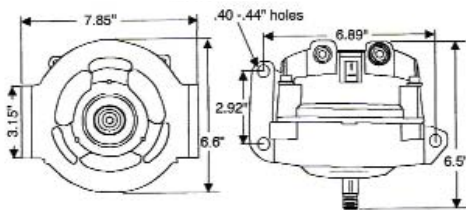

| 200/170 AMPS | | |
|---------------|------|-----|
| PX-2-5 SERIES | | |
| ROTOR RPM | AMPS | |
| | COLD | HOT |
| 1800 | 70 | 60 |
| 2000 | 95 | 80 |
| 2250 | 115 | 95 |
| 2500 | 135 | 115 |
| 2750 | 145 | 120 |
| 3000 | 155 | 130 |
| 3500 | 170 | 140 |
| 4000 | 175 | 145 |
| 4500 | 180 | 150 |
| 5000 | 185 | 155 |
| 5500 | 190 | 160 |
| 6000 | 200 | 170 |

PX-5PD

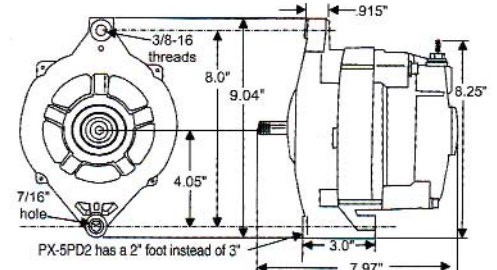

PX-5RD

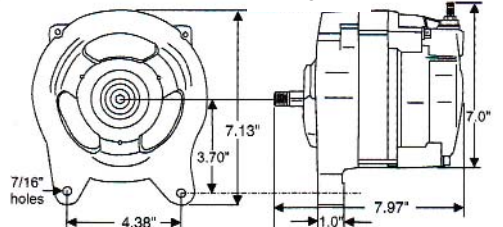

PX-5TD

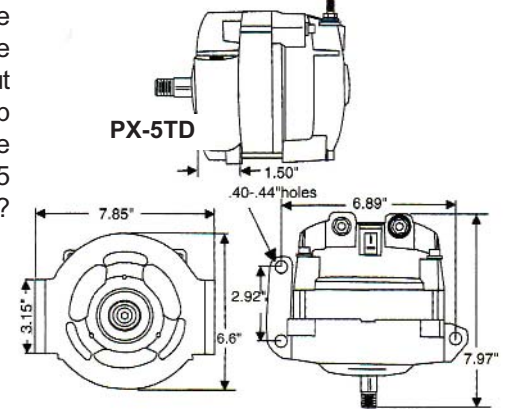

Above is a PX-2 Series Output Chart. The PX-5 Series charts are below. Note that we list both Hot & Cold Amperage Outputs. All alternators drop in output when they get hot. Some brands drop much more than others. Except for the length, all dimensions between the 2 & 5 are the same. What are the differences?

- 1) A PX-5 has a longer (front to rear) stator and rotor than a PX-2. This gives a PX-5 alternator more output than a PX-2.
- 2) A PX-2 alternator has two heat sinks inside the rear case. One has positive diodes in it,

and one has negative diodes in it. One large post is positive and the other is negative. Beginning in 2005, both heat sinks inside the PX-5 have positive diodes. Both posts are positive and there is a connector, or bridge, between the two posts. The PX-5 negative diodes are in the rear housing. 3) A PX-5 has a larger rear bearing than a PX-2 to handle the larger rotor. 4) A PX-7 is a PX-5 with a PX-2 rear housing (plus other changes). It is about 1/4" shorter than a PX-5.



PX-5 Negative Diodes in rear housing

| 230/190 AMPS | | |
|------------------|------|-----|
| MODEL PX-5/7-230 | | |
| ROTOR RPM | AMPS | |
| | COLD | HOT |
| 1800 | 110 | 90 |
| 2000 | 130 | 110 |
| 2250 | 155 | 130 |
| 2500 | 170 | 140 |
| 2750 | 185 | 155 |
| 3000 | 195 | 160 |
| 3500 | 210 | 175 |
| 4000 | 215 | 180 |
| 4500 | 225 | 185 |
| 5000 | 230 | 190 |

| 250/210 AMPS | | |
|------------------|------|-----|
| MODEL PX-5/7-250 | | |
| ROTOR RPM | AMPS | |
| | COLD | HOT |
| 1800 | 95 | 80 |
| 2000 | 125 | 105 |
| 2250 | 145 | 120 |
| 2500 | 175 | 145 |
| 2750 | 190 | 160 |
| 3000 | 205 | 170 |
| 3500 | 225 | 185 |
| 4000 | 235 | 195 |
| 4500 | 240 | 200 |
| 5000 | 250 | 210 |

PERFORMANCE, ENDURANCE AND SATISFACTION

PennTex
 INDUSTRIES, INC.

Manufacturers of
 High Efficiency Alternators and
 Mobile Electronic Devices.

Corporate:
 202 Plaza Drive
 Manchester, PA 17345
 Ph: 717-266-8762
 Fax: 717-266-7803

Manufacturing:
 7620 Flagstone Drive
 Fort Worth, TX 76118
 Ph: 817-590-2818, Toll Free: 877-590-7366
 Fax: 817-590-0505, Tech Fax: 817-590-0398

www.penntexusa.com
 email: sales@penntexusa.com or
 tech@penntexusa.com