

### HIGH AMPERAGE / HEAVY DUTY ALTERNATORS / CHARGING SYSTEMS

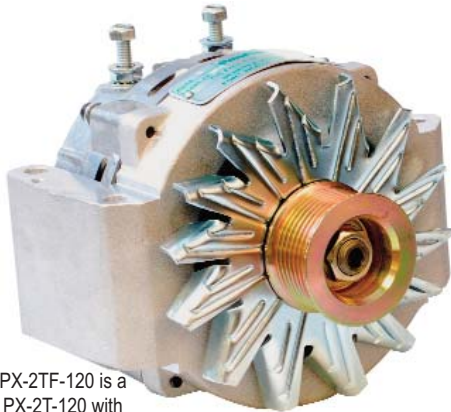

PX-2TF-120 is a PX-2T-120 with 1/2" tall spacers under the three mounting points.

**PX-2T-120  
PX-2TF-120**



**PX-2R-120**  
MOUNT HOLES ARE 8mm DIAMETER



**PX-2P-120**  
3" FOOT (PX-2P-2 HAS A 2" FOOT)



**PX-4024 24-VOLT  
REGULATOR**

THE PX-2 24-VOLT 120-AMP SERIES HAS SUPERSEDED THE PX-2 24-VOLT 130-AMP SERIES.

#### 120/102 AMPS

PX-2-120 SERIES - TESTED AND PROVEN		
ROTOR RPM	AMPS @ 27.5 VOLTS	
	COLD (SAE)	HOT (200°F)
2000	50	43
2250	65	55
2500	80	68
2750	90	77
3000	95	81
3500	105	89
4000	110	94
4500	115	98
5000	120	102

#### APPLICATIONS

- Transit Buses, Motor Coaches and Heavy-duty Industrial Equipment, EMS/Fire/Ambulance.
- Commercial Trucking/Refrigeration, Lift Trucks and Material Handling.
- Contact PennTex for more information.

#### OPTIONS

- A variety of case mount styles, 6 & 8-groove serpentine pulleys are available.

#### Complete Kit Part # / Alternator Only

*(A Complete Kit is an Alternator, Regulator, & Harness)*

PX-212P Complete Kit / PX-2P-120 Alternator only  
 PX-212P2 Complete Kit / PX-2P2-120 Alternator only  
 PX-212R Complete Kit / PX-2R-120 Alternator only  
 PX-212T Complete Kit / PX-2T-120 Alternator only  
 PX-212TF Complete Kit / PX-2TF-120 Alternator only  
 All of the Complete Kits listed above use a PX-4024 Voltage Regulator and a PX-2502-2 Wire Harness.



## Special Features

- 1) 5/16" output & ground posts.
- 2) Heavy duty hand wound high output stator.
- 3) Heavy duty dual-plain balanced rotor.
- 4) Heavy duty long life brushes.
- 5) Heat sinks designed for efficient cooling.
- 6) Heavy duty bearings with high temperature seals and grease.
- 7) Twelve (12) press fit heavy duty diodes.
- 8) Specially designed heavy duty 24-volt regulator that produces higher output ratings; runs cooler than current industry standards.
- 9) Regulator has ground fault and high voltage protection.
- 10) GXL wire is standard in all harnesses.
- 11) Weight: Approximately 20 pounds.

**PennTex Industries** recommends using a minimum of 2 gauge battery and ground cable. For maximum performance route 2 gauge battery cable or larger from the alternator battery post directly to the battery positive stud. The ground cable from the alternator should also be a minimum of 2 gauge cable and should be bolted directly to a chassis ground or the negative side of the battery.

### WARRANTY

PENNTEx INDUSTRIES, INC. ALTERNATORS USED ON WELDER, INVERTER, AND SPECIAL 24-VOLT APPLICATIONS HAVE A LIMITED TWELVE (12) MONTH WARRANTY THAT DOES NOT INCLUDE ANY LABOR OR FREIGHT ALLOWANCE.

## 24-Volt PX-2 Dimensions

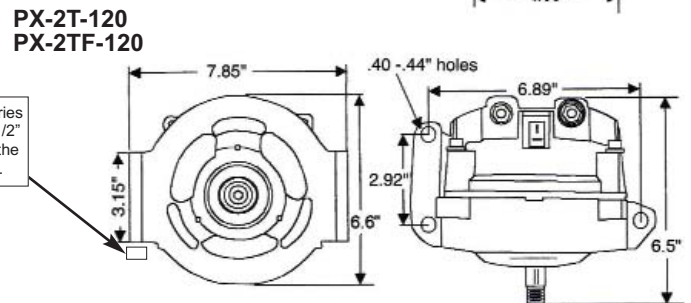
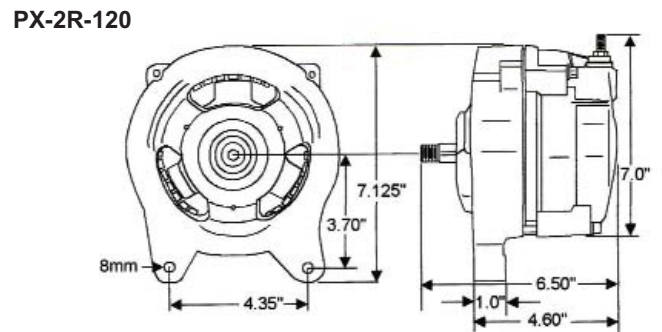
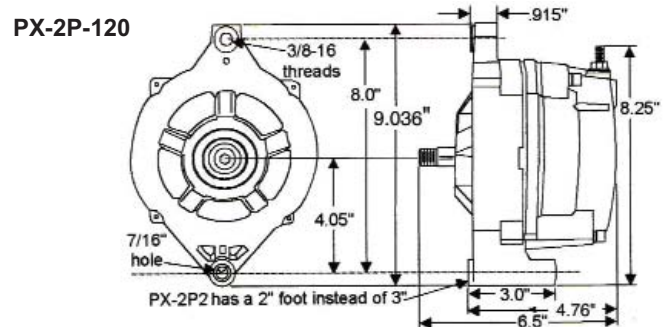

ALL DIMENSIONS ARE LISTED FOR QUICK REFERENCE. CONTACT PENNTEx FOR PRECISE MEASUREMENTS IF REQUIRED FOR BRACKETS OR SPECIAL APPLICATIONS.

## PERFORMANCE ENDURANCE AND SATISFACTION

**PennTex**  
INDUSTRIES, INC.

Manufacturers of  
High Efficiency Alternators and  
Mobile Electronic Devices.

**Corporate:**  
202 Plaza Drive  
Manchester, PA 17345  
Ph: 717-266-8762  
Fax: 717-266-7803

[www.penntexusa.com](http://www.penntexusa.com)  
email: [sales@penntexusa.com](mailto:sales@penntexusa.com)  
[tech@penntexusa.com](mailto:tech@penntexusa.com)

**Manufacturing/ Sales/ Tech/ Warranty:**  
7620 Flagstone  
Fort Worth, TX 76118  
Ph: 817-590-2818  
Toll Free: 877-590-7366  
Fax: 817-590-0505, Tech Fax: 817-590-0398