

HIGH AMPERAGE / HEAVY DUTY ALTERNATORS / CHARGING SYSTEMS



PX-2TF-120 is a PX-2T-120 with 1/2" tall spacers under the three mounting points.

**PX-2T-120
PX-2TF-120**



PX-2R-120
MOUNT HOLES ARE 8mm DIAMETER

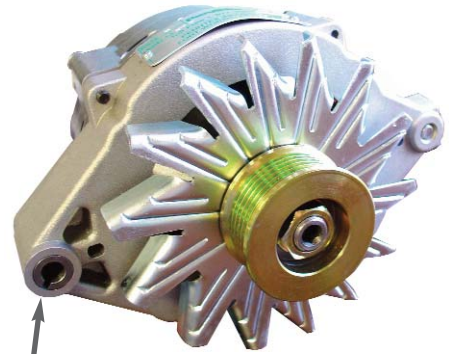

PX-2P-120
3" FOOT (PX-2P-2 HAS A 2" FOOT)



**PX-4024 24-VOLT
REGULATOR**

THE PX-2 24-VOLT 120-AMP SERIES HAS SUPERSEDED THE PX-2 24-VOLT 130-AMP SERIES.

120/102 AMPS

PX-2-120 SERIES - TESTED AND PROVEN		
ROTOR RPM	AMPS @ 27.5 VOLTS	
	COLD (SAE)	HOT (200°F)
2000	50	43
2250	65	55
2500	80	68
2750	90	77
3000	95	81
3500	105	89
4000	110	94
4500	115	98
5000	120	102

APPLICATIONS

- Transit Buses, Motor Coaches and Heavy-duty Industrial Equipment, EMS/Fire/Ambulance.
- Commercial Trucking/Refrigeration, Lift Trucks and Material Handling.
- Contact PennTex for more information.

OPTIONS

- A variety of case mount styles, 6 & 8-groove serpentine pulleys are available.

Complete Kit Part # / Alternator Only

(A Complete Kit is an Alternator, Regulator, & Harness)

PX-212P Complete Kit / PX-2P-120 Alternator only
 PX-212P2 Complete Kit / PX-2P2-120 Alternator only
 PX-212R Complete Kit / PX-2R-120 Alternator only
 PX-212T Complete Kit / PX-2T-120 Alternator only
 PX-212TF Complete Kit / PX-2TF-120 Alternator only
 All of the Complete Kits listed above use a PX-4024 Voltage Regulator and a PX-2502-2 Wire Harness.



Special Features

- 1) 5/16" output & ground posts.
- 2) Heavy duty hand wound high output stator.
- 3) Heavy duty dual-plain balanced rotor.
- 4) Heavy duty long life brushes.
- 5) Heat sinks designed for efficient cooling.
- 6) Heavy duty bearings with high temperature seals and grease.
- 7) Twelve (12) press fit heavy duty diodes.
- 8) Specially designed heavy duty 24-volt regulator that produces higher output ratings; runs cooler than current industry standards.
- 9) Regulator has ground fault and high voltage protection.
- 10) GXL wire is standard in all harnesses.
- 11) Weight: Approximately 20 pounds.

PennTex Industries recommends using a minimum of 2 gauge battery and ground cable. For maximum performance route 2 gauge battery cable or larger from the alternator battery post directly to the battery positive stud. The ground cable from the alternator should also be a minimum of 2 gauge cable and should be bolted directly to a chassis ground or the negative side of the battery.

WARRANTY

PENNTEx INDUSTRIES, INC. ALTERNATORS USED ON WELDER, INVERTER, AND SPECIAL 24-VOLT APPLICATIONS HAVE A LIMITED TWELVE (12) MONTH WARRANTY THAT DOES NOT INCLUDE ANY LABOR OR FREIGHT ALLOWANCE.

24-Volt PX-2 Dimensions

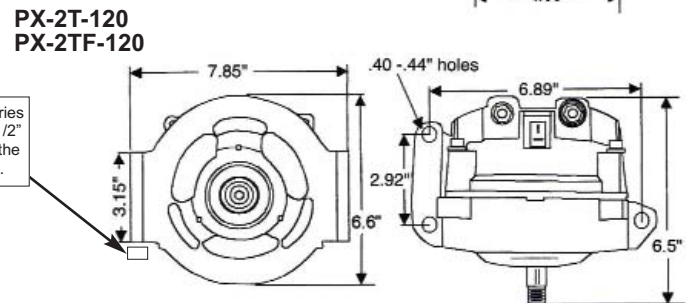
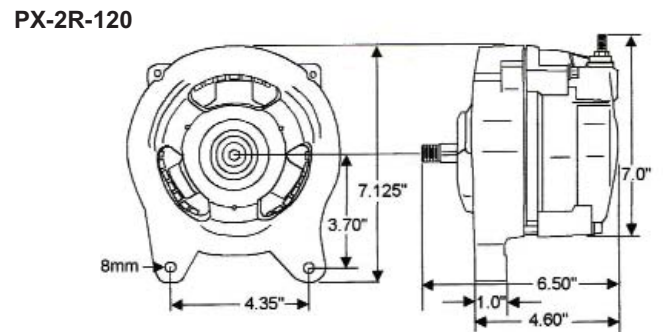
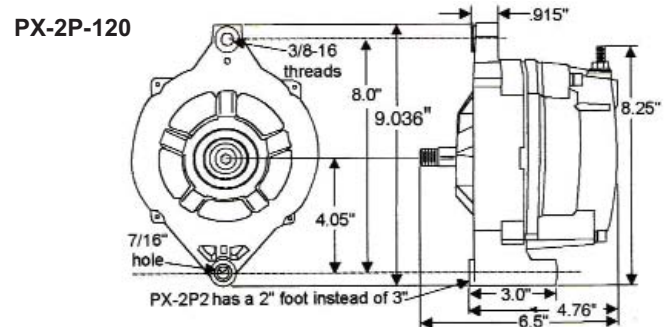

ALL DIMENSIONS ARE LISTED FOR QUICK REFERENCE. CONTACT PENNTEx FOR PRECISE MEASUREMENTS IF REQUIRED FOR BRACKETS OR SPECIAL APPLICATIONS.

PERFORMANCE ENDURANCE AND SATISFACTION

PennTex
INDUSTRIES, INC.

Manufacturers of
High Efficiency Alternators and
Mobile Electronic Devices.

Corporate:
202 Plaza Drive
Manchester, PA 17345
Ph: 717-266-8762
Fax: 717-266-7803

www.penntexusa.com
email: sales@penntexusa.com
tech@penntexusa.com

Manufacturing/ Sales/ Tech/ Warranty:
7620 Flagstone
Fort Worth, TX 76118
Ph: 817-590-2818
Toll Free: 877-590-7366
Fax: 817-590-0505, Tech Fax: 817-590-0398